

Exone

Gaming wheel

Operation manual

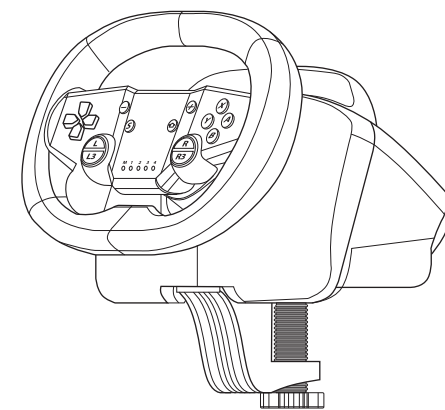

Racing Wheel	SWITCH	PS3/PS4	PC-Xinput	PC-Dinput	Android
A	A	○	A	3	A
B	B	X	B	2	B
X	X	△	X	4	X
Y	Y	□	Y	1	Y
L3	L3	L3	LS	9	L3
R3	R3	R3	LS	10	R3
L	L	L1	LB	5	L1
R	R	R1	RB	6	R1
—	—	SELECT	BACK	7	SELECT
+	+	START	START	8	START
HOME	HOME	PS	MODE	MODE	/
Right trigger ZR	ZR	R2	RT	Z axle	R2
Left Trigger ZL	ZL	L2	LT	Z rotation axis	L2
Turn	LX	LX	LX	LX	LX
Arrow key	Arrow key	Arrow key	Arrow key	Arrow key	Arrow key

Table mount

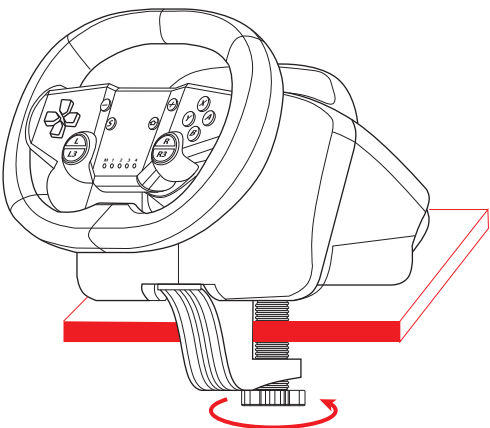

Wheel settings

Dead zone adjustment¹

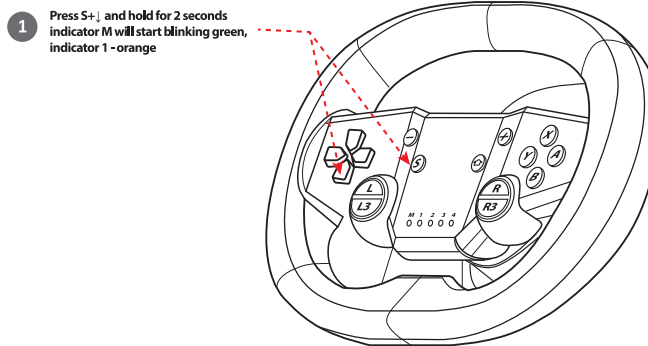

- 1 Press S+ and hold for 2 seconds, indicator M will start blinking green, indicator 1 - orange

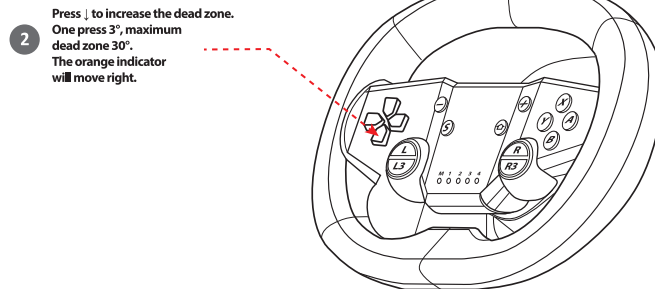

- 2 Press ↓ to increase the dead zone. One press 3°, maximum dead zone 30°. The orange indicator will move right.

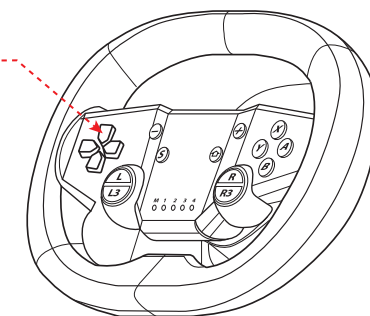

- 3 Press ↑ to reduce the dead zone. One press 3°. The orange indicator will move to the left.

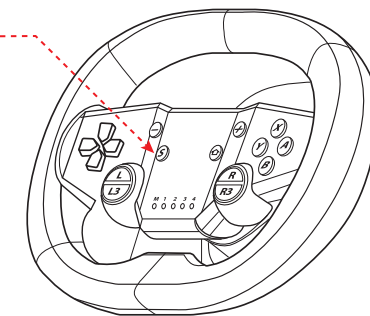

- 4 To complete the setting, press S. The M indicator will turn green, indicator 1 - orange

- 5 To return the dead zone settings to the default, press and hold S for 5 sec

¹ default dead zone 0°

Adjusting the vibration strength²

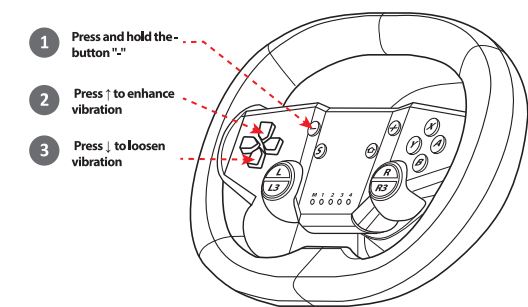

- 1 Press and hold the button "L3"
- 2 Press ↑ to enhance vibration
- 3 Press ↓ to loosen vibration

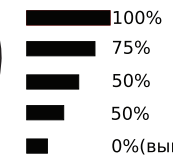

² default vibration strength is 75%

Reset to factory settings³

Press and hold L3+R3 for 5 seconds

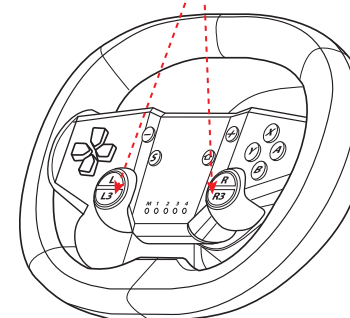

³ When connecting the steering wheel to another device, it is recommended to do return to factory settings

Connecting to Windows

Remove the back cover



Press up

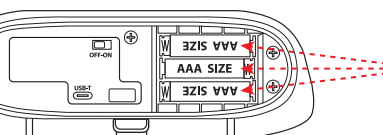

Insert 3 AAA batteries

Wire connection⁴

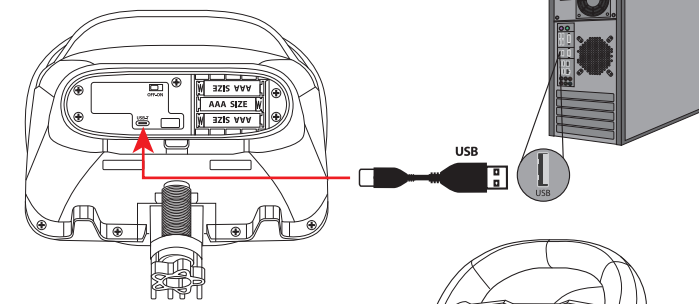

⁴ With a wired connection, the steering wheel can be used without batteries

Changing XInput/Dinput mode

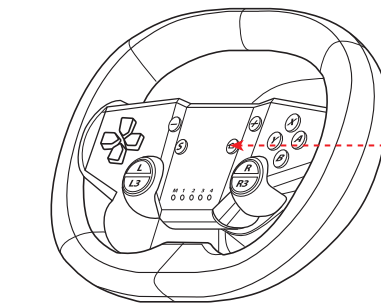

Press and hold Home 5 seconds

Bluetooth connection⁵

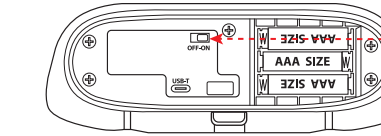

1 Turn the switch to ON position

2 Press and hold R

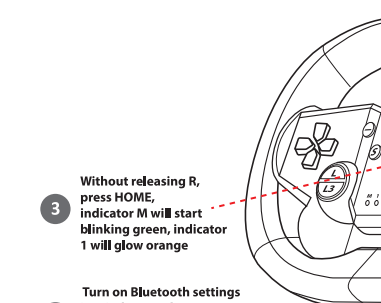

- 3 Without releasing R, press HOME, indicator M will start blinking green, indicator 1 will glow orange

- 4 Turn on Bluetooth settings in Windows and connect to the device Xbox Wireless Controller, the M indicator will glow green, indicator 1 - orange

⁵ Bluetooth adapter is not included in the pack

Checking the serviceability of the steering wheel

- 1 Press WIN+R on your computer keyboard
- 2 In the window that opens, type joy.cpl and click OK
- 3 In the window that opens, select the steering wheel and click the "Properties" button
- 4 Turn the steering wheel and press the buttons to make sure they work

Connecting to Android



Press up

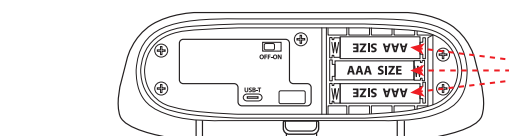

Connection via Shootingplus V3 app⁶

- 1 Download and install the Shootingplus V3 application from Google Play



- Press and hold button A
- Without releasing A, press Home, indicator M will start blinking red, indicator 1 glows orange

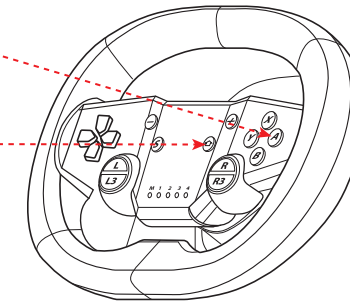

- Turn on Bluetooth on your smartphone and connect to the device V3-DOYO Wheel Indicator M will turn red, LED 1 will turn orange

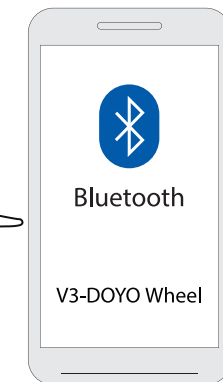

- Launch the ShootingPlus V3 application and follow the application instructions

⁶ The application allows you to use the gamepad in games, which do not support gamepad control. The app doesn't work with phones based on MediaTek (MTK) chips

Connect without installing the application⁷

- Press and hold the X button
- Without releasing X, press Home, the M indicator will start blinking blue, indicator 1 glows orange
- Turn on Bluetooth on your smartphone and connect to the device HID-DOYO Wheel Indicator M will turn blue, LED 1 will turn orange

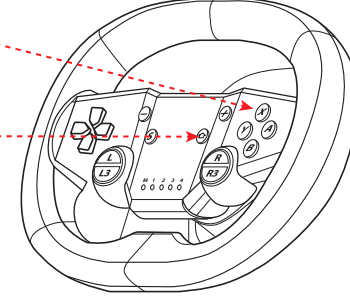

⁷ This method allows you to connect a gamepad to phones based on MediaTek (MTK) chips

Checking the serviceability of the steering wheel

- Download and install the Gamepad Tester application from Google Play
- Turn the steering wheel and press the buttons to make sure they work



Connecting to iPhone Connection in MFI mode

- Press and hold button B
- Without releasing B, press Home, the M indicator will start blinking red, indicator 1 glows orange
- Turn on Bluetooth on your iPhone and connect to the device DUALSHOCK4. Indicator M will turn red, LED 1 will turn orange

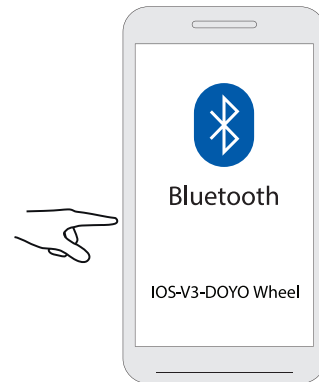
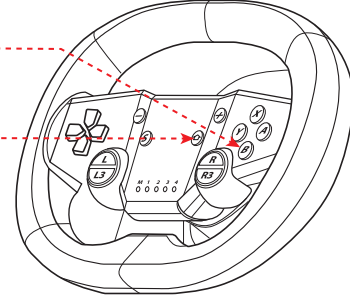

Connection via Shootingplus V3 app⁸

- Download and install the Shootingplus V3 application from the AppStore
- Press and hold the Y button
- Without releasing Y, press Home, the M indicator will start blinking blue, indicator 1 glows orange
- Turn on Bluetooth on your iPhone and connect to the device IOS-V3-DOYO Wheel. Indicator M will turn blue, LED 1 will turn orange
- Launch the ShootingPlus V3 application and follow the application instructions

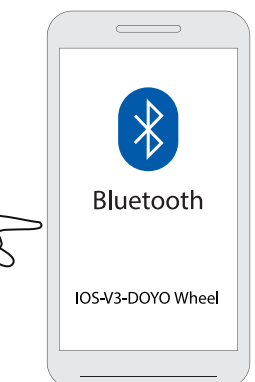
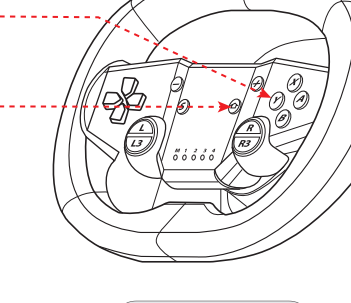

⁸ Works only with iOS version 13.4 and below

Connecting to PlayStation 3

Stage I: wired pairing with the set-top box (once, upon first connection)

- Put the switch to OFF position
- Connect the steering wheel with a wire to the console
- Wait until the M indicator starts constantly glowing red

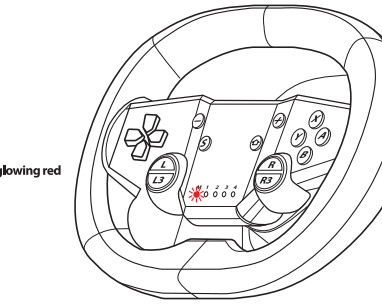
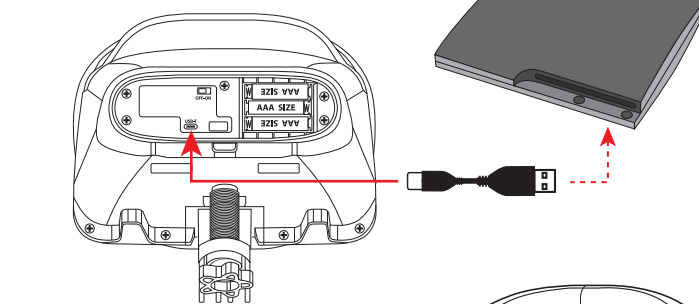
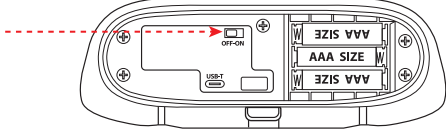

Connecting to PlayStation 4

Stage I: wired pairing with the set-top box (once, upon first connection)

- Put the switch to ON position
- Disconnect the wire from the console and steering wheel
- Wait until the M indicator starts glows blue constantly

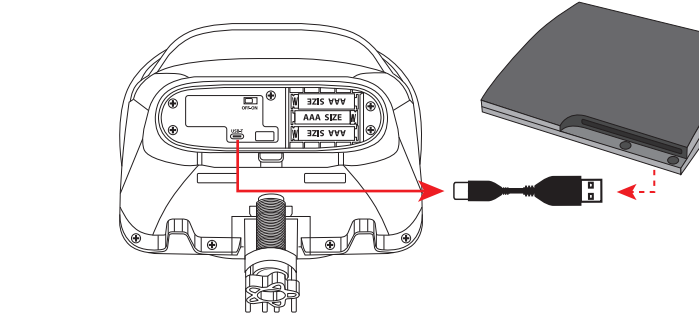
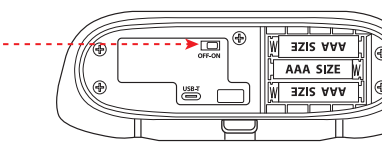

The steering wheel will connect to the PS3 via Bluetooth and you can play

Stage II: wireless use of the steering wheel (continuous operation)

- Put the switch to ON position
- Wait for connection (3-5 seconds)

Connecting to PlayStation 4

Stage I: wired pairing with the set-top box (once, upon first connection)

- Put the switch to OFF position
- Connect the steering wheel with a wire to the console
- Wait until the M indicator starts glows blue constantly

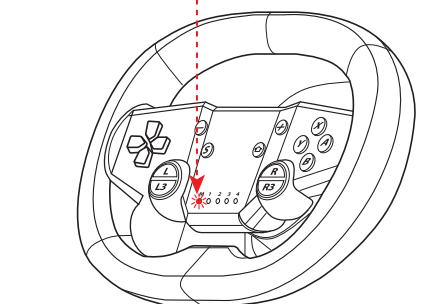
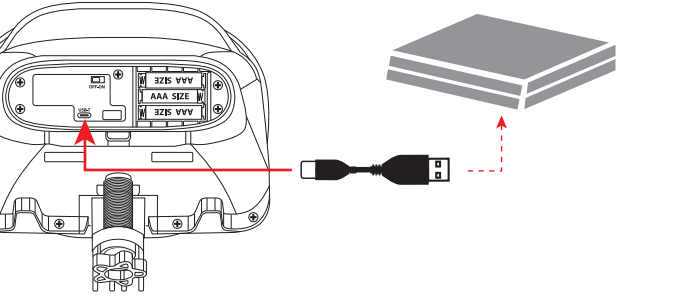
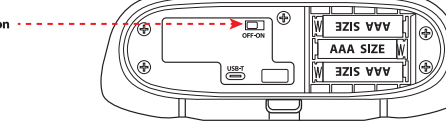

Connecting to PlayStation 4

Stage I: wired pairing with the set-top box (once, upon first connection)

- Press and hold Home for 1 second, indicator M will start glow green
- Place the switch in the ON position
- Disconnect the wire from the console and steering wheel

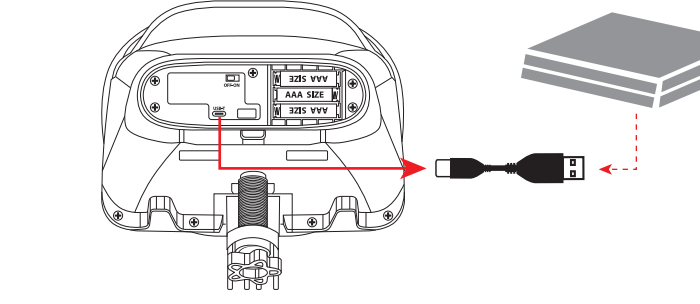
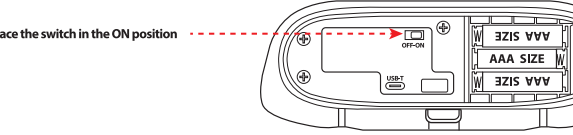
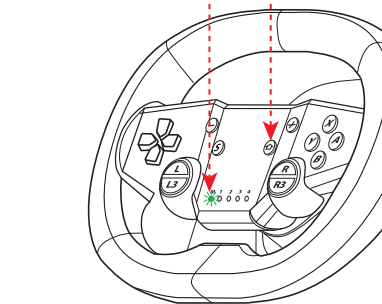

The steering wheel will connect to the PS4 via Bluetooth and you can play

